

Superstar 1000 LED Followspot

Users Manual

Following are the general terms and conditions of sales relating to equipment manufactured and/or sold by Lycian Stage Lighting.

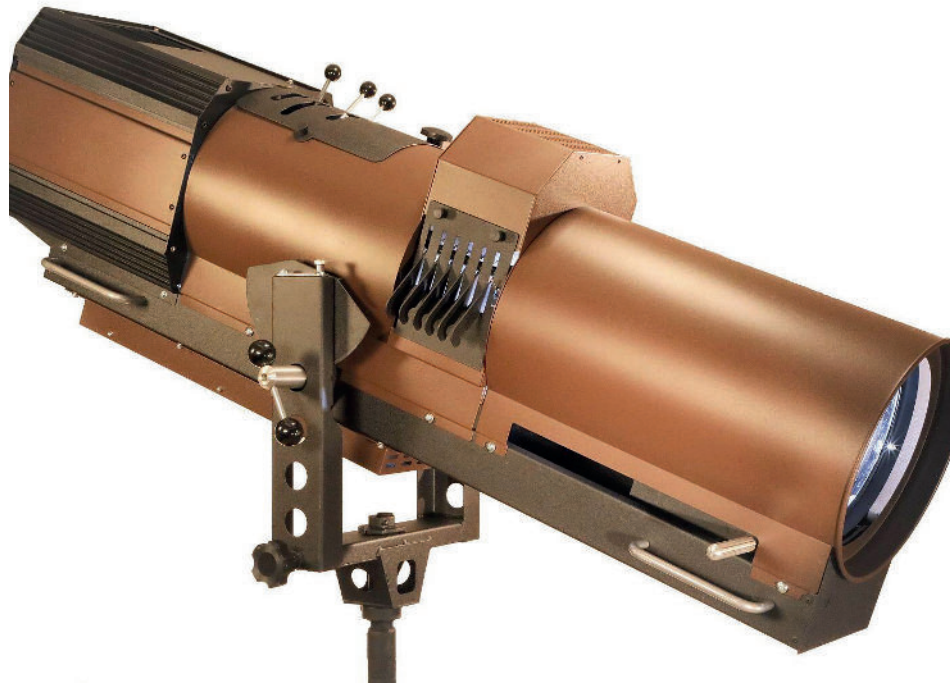

Introduction

Congratulations on choosing the Lycian Stage Lighting Superstar 1000 LED! It's a high-quality theatrical lighting fixture. Lycian followspots undergo rigorous manufacturing processes and thorough inspections to ensure top-notch performance. However, if your unit appears damaged in any way, contact your Lycian distributor immediately.

To best acquaint yourself, and for safe operations, please read the user instruction manual prior to using your new followspot. Improper user can be a safety hazard, degrade performance and/or void warranty. Lycian Stage Lighting is not liable for damages whether direct, indirect, or incidental resulting from customer's failure to follow proper operational and safety procedures.

Important Safety Information

1. This product is designed for interior use only. Avoid use in areas where water can contact the fixture, which can result in failure, damage or fire.
2. Servicing should be by a qualified technician.
3. Use only Lycian original components.
4. Avoid staring directly at the LED light source.
5. Disconnect light from electrical service before servicing.
6. Do not open the lamphouse when light is running.

Fixture Safety

1. Ensure that the base is on a stable, level floor or platform.
2. Use proper cables to secure fixture if hung using proper length and cable strength.
3. Allow fixture to cool before servicing as surfaces will be hot.
4. Do not tamper with or bypass unit's safety features. Do not use if the product has been damaged by accident, has been unreasonably neglected, improperly used, or following attempted repairs by unauthorized personnel.
5. Inspect power cord and connector for damage before each use.

Ventilation

1. Keep away from flammable materials.
2. Do not cover while in use.
3. Keep vents clear to avoid overheating and allow for adequate ventilation.
4. Ensure fan is clean and spinning freely. If fan is not operating properly, shut unit off and have unit serviced.

Cleaning

1. Never touch LED source with fingers.
2. LED may be cleaned with a gentle blast of compressed air twice annually or as required.
3. Use a gentle lens cleaner or alcohol cleaner on lenses.
4. Avoid wetting housing controls. Keep liquid away from interior.

Packing Contents

Followspot Head
Yoke
Pole
Base with casters
Power Cord with Connector
User Manual
Warranty and Registration Card

Setup

The Superstar 1000 (1281) comes in two parts - the head assembly and base assembly. First, remove the base from the shipping container and lower the four legs and screw each one into the base with the captive screw on the legs. The base pole can be inserted into the base with the notch on the top. Lower the yoke assembly onto the base pole and tighten the hex head bolt at the bottom of the yoke. Tighten the gold height levers to lock the pole into the base.

Loosen the brake handle to accept the light, unscrew the yoke hold down clips and move them out of the way to lower light onto the yoke. Lift the light onto the yoke, tighten the brake handle and tighten down the yoke hold down clips. Next, tighten the leveling jacks to stabilize the light and ensure it stays securely in place.

The light may also be hung, but it must be secured using safety cables rated to support its full weight. A hanging yoke must be purchased in order to hang the light.

Electrical Connection

Please note, the fixture must be grounded.

Input voltage range:

100-120V AC, 50/60 Hz

200-240V AC, 50/60 Hz

Input current at 100-120V = 10 amps

Input current at 200-240V = 6 amps

The supply cord has a Power Con connector with the following color code:

Green/Yellow Stripe = Ground/Earth

Blue = Neutral (used as a live line at 200-240 VAC)

Brown = Live

Line cord is #14 AWG

DMX

DMX IN / OUT 5 POLES:

PCB dimensions (mm)

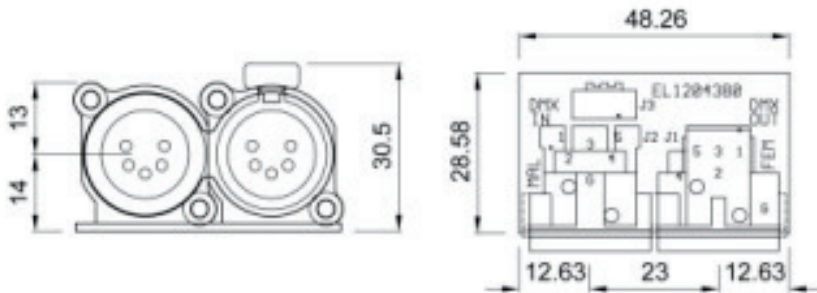

Mechanical dimensions (mm)

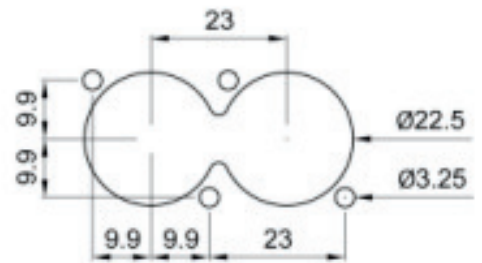

5. DMX CHARTS

This DMX chart refers to the fixture set with default parameters:

DMX channel	Function	Type of control	Effect	Decimal	Percentage
1	Master dimmer	Proportional	Adjust luminous output intensity from 0 to 100%	0 - 255	0% - 100%
Fixture: Imperium			Table name: DMX 512 function - Chart 1	Edition: 1	Date: 08/02/2021

This DMX chart refers to the fixture set with 16 bits resolution (see Menu → Function → DMX Chan):

DMX channel	Function	Type of control	Effect	Decimal	Percentage
1	Master dimmer	Proportional	Adjust luminous output intensity from 0 to 100%	0 - 255	0% - 100%
2	Dimmer fine	Proportional	Fine dimmer control 16 bit	0 - 255	0% - 100%
Fixture: Imperium			Table name: DMX 512 function - Chart 2	Edition: 1	Date: 08/02/2021

DMX A001
0%

MENU
Mode

MODE
Dmx

MODE
Manual

MENU
Function

FUNCTION
Test

FUNCTION
Curves

FUNCTION
Dmx Chan

FUNCTION
Smooth

FUNCTION
Dmx Fail

FUNCTION
ScrSaver

MENU
Measure

MEASURE
Temper

MEASURE
Dmx

MEASURE
Input

MEASURE
Iout Set

MEASURE
Output

MEASURE
Timers

MEASURE
Alarm

MEASURE
Release

Main Menu:

The **Main** menu is displayed when the driver is turned on:

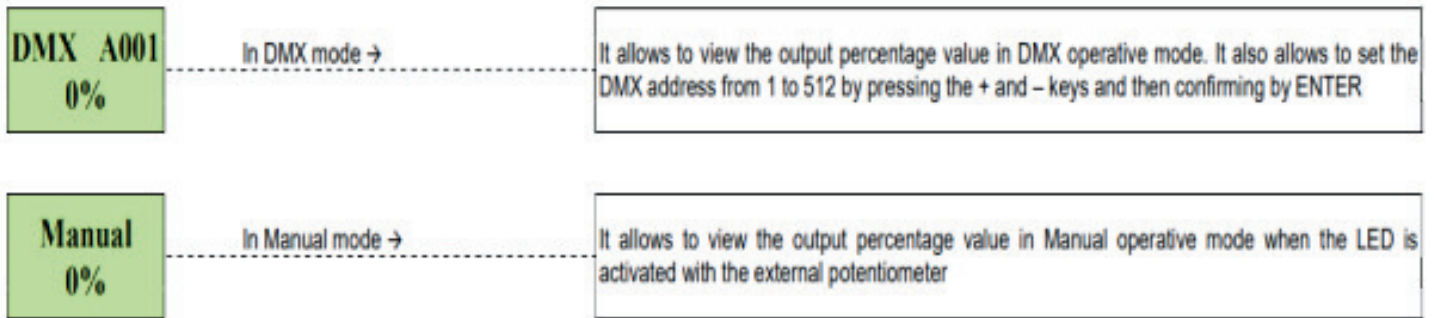

Mode Menu:

The **MODE** menu allows to choose between 2 operative modes: Dmx or Manual.

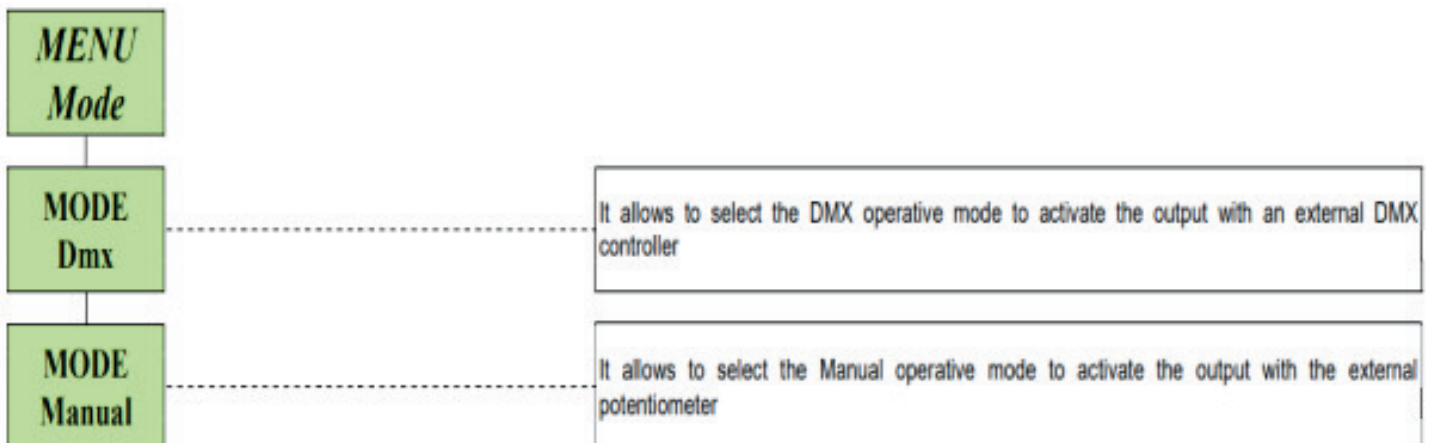

Function Menu:

The **FUNCTION** menu allows to change and customize some functional settings of Imperium, e.g. dimming curve, DMX channels etc... For more details please refer to the schematic below:

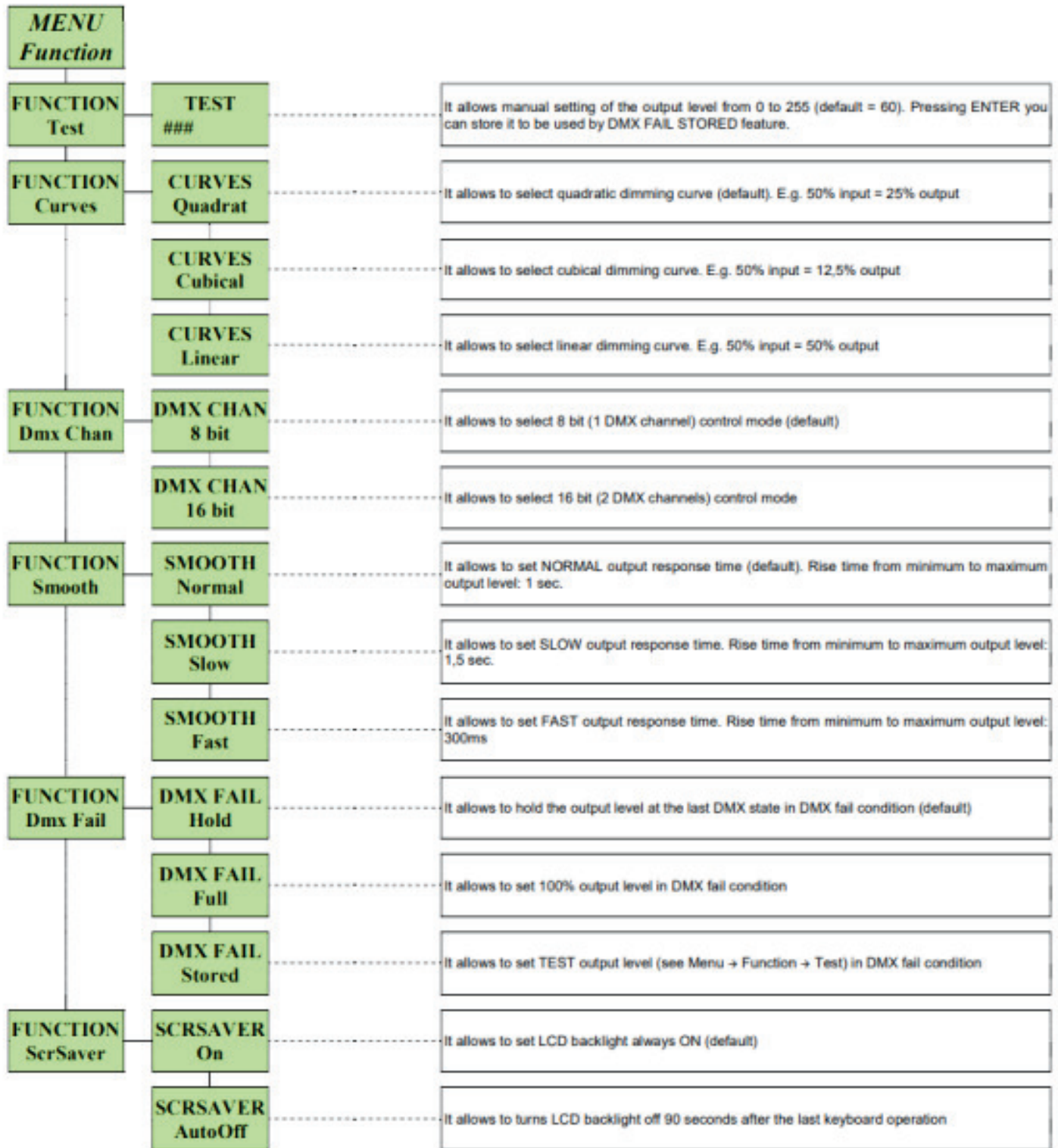

Measure Menu:

The **MEASURE** menu allows access to key parameter measurements of the device such as for instance, internal temperature, Voltage, POH counter (total power on hours, to measure device life), etc. For more details please refer to the schematic below:

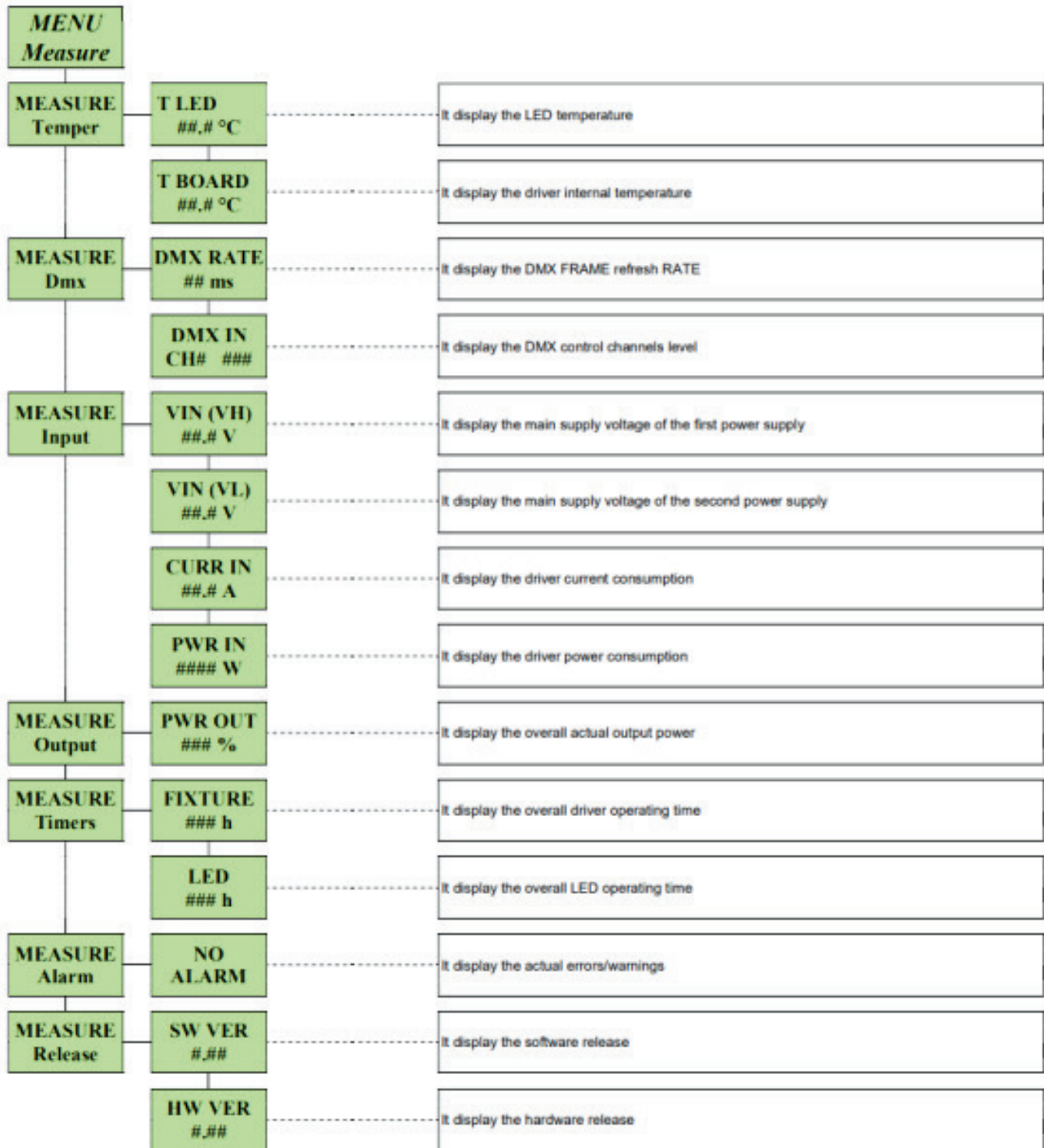

Controls

The Superstar 1000 (1281) uses top-mounted controls giving the user the ability to operate from the right or left side.

Chopper: located toward the rear of the light, will allow you to chop the top and bottom of the beam. This isn't meant to be used as a blackout for the light.

Iris: located in front of the chopper, is used to increase or decrease the size of the beam. This iris provides a full blackout.

Fader: located in front of the iris handle, is used to blackout the light. This can also be controlled with DMX. An optional electronic fader is available upon request.

Fine Focus: a round handle located on the top of the light used to create a sharp or soft edge.

Front Lens: moveable to get a wider or tighten beam. The user would move the lens back for a wider beam and forward for a tighter beam.

Boomerang: the light is equipped with a six-color, self-cancelling boomerang. You can lock in as many color frames as needed simultaneously. A single lever allows you to release all frames at once, and the mechanism can be reversed for left-handed operation.

Tilt Knob: this adjusts the desired resistance for smooth up-and-down movement during operation.

Pan Knob: this adjusts the desired resistance for left to right movement of the light.

DMX: the DMX input and output is located on the rear of the light next to the LCD display. The provides the ability to 'Daisy Chain' the DMX to other lights, if necessary.

Gobo Slot: this is located on the top toward the front of the lamphouse.

Cleaning & General Maintenance

Periodic maintenance can ensure optimal performance and avoid issues before they occur. Always perform maintenance to a unit that is disconnected from power and is cold. Clear air intakes and fans of dust and other dirt. Adequate ventilation is required for proper operation of the power supply and LED engine. Blow out dust from the LED heatsink at least once every six months or as necessary. Use alcohol wipes or a suitable lens cleaner to clean lenses. We recommend cleaning the iris using a dry powdered moly lubricant. The guide rods can be lubricated with Super Lube, a high-quality synthetic grease.

Avoid touching the lenses or LED with your fingers. Never connect the light to a dimmer panel.

Troubleshooting

If the light fails to illuminate, the following guide may help to restore operation:

1. Verify that the outlet has supply voltage and that it matches the required voltage for the unit.
2. Ensure the 15A breaker has not 'popped' on the left side of the light.
3. Look at the LCD display to see if you are in manual or DMX mode.
4. Refer to panel instructions to change from one to the other.

Spare Parts

All components for the Superstar 1000 are available from Lycian or through your authorized Lycian distributor. Avoid use of aftermarket products, as they may not be built to Lycian standards and could be dangerous. Please call Lycian technical support with any questions concerning repair or replacement of any electrical component.

Warranty

All Lycian followspots are backed by a three-year limited warranty against defects in workmanship and materials. For more information, please contact the authorized Lycian distributor from whom you made your purchase.