

MIDGET

■ MODEL
1206



■ CAN GO
FROM THE
SMALLEST PIN
SPOT TO THE
LARGEST FULL
STAGE FLOOD

Brighter, smaller, quieter and more flexible than any of its competitors, the MIDGET does away with the need to have two different followspots to cover all spot sizes and intensities. With the exclusive spread

lens system, the MIDGET can go from the smallest pin spot to the largest full stage flood. Users will find the moderately priced Lycian MIDGET built to the highest and most rigid professional standards with a host of the niceties that make the unit a joy to use and service.

■ FEATURES

- Uses readily available FEL 1000 watt quartz lamp
- Quiet operation
- Automatic, self cancelling color boomerang
- Balanced for perfect weight distribution at any angle
- Spread lens system
- Adjustable brakes for pan and tilt
- Iris and trim shutters
- Gobo slot
- UL listed

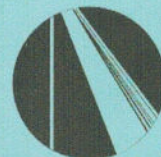

LYCIAN
STAGE LIGHTING

The luminaire shall be a 1000 watt follow spotlight designed to accept only a FEL quartz lamp. The gate assembly shall have a heavy duty nichrome iris with stainless steel trim shutters controlled by top mounted external controls. The luminaire shall include an automatic self-cancelling color boomerang that features self captive match plates for each frame. Individual or removable frames shall not be acceptable. The boomerang shall also include a dowser. The luminaire shall include an externally controlled spread lens. This lens shall efficiently spread the light in a horizontal position for stage flood lighting. The lamp holder shall be mounted on an adjustable bracket to allow adjustment of the field. The optical train shall contain only optical grade lenses. Green or plastic lenses shall not be acceptable. Relamping shall be accomplished by releasing the 1/4 turn fasteners opening the top door. A rocker switch and line cord terminated in a NEMA 5 -15P (15 ampere parallel blade U-ground male) con-

nectors shall be provided. The quiet cooling fans shall maintain a low operating temperature and a lamp socket temperature well below the established standards. The floor stand shall be of the three-legged casted telescoping type. The yoke shall allow for a downward tilt of 60 degrees below the horizontal and 55 degrees above the horizontal. Current draw at 120 VAC shall not exceed ten amperes. Housing shall be of extruded aluminum and cold rolled sheet steel finished in a powder coated baked epoxy finish. Housing dimensions shall not exceed 32" (L) x 13" (H) x 15" (W) including all controls. Net weight shall not exceed 40 lbs. for the spotlight and 21 lbs. for the floor stand. Photometric data shall conform to the table provided. The luminaire shall be a Lycian Stage Lighting Midget Model 1206. The luminaire shall be UL listed and labeled for use with 1000 watt FEL quartz lamp.

PHOTOMETRICS

Throw	40ft.	60ft.	80ft.	100ft.	120ft.
Small Spot					
Footcandles	250	111	62.5	40	27
Diameter (in.)	8	12	16	20	24
Large Spot					
Footcandles	250	111	62.5	40	27
Diameter (ft.)	6.5	9.75	13.0	16.25	19.5
Large Spot (Spread Lens)					
Footcandles	115	52	28	17	12
Max. width of beam (ft.)	6.5	9.75	13.0	16.0	19.5
Max. height of beam (ft.)	13.0	19.5	26.0	32.5	39.0

ORDERING CODE 1206

- 1206 - Midget
- 1206/D - Midget with Dimmer
- 1206/HY - Midget with Hanging Yoke
- 1206/240 - Midget 240 volt
- 1206/HY/D - Midget w/Hanging Yoke/Dimmer
- 1206/HY/240 - Midget with Hanging Yoke 240 volt

Dimensions

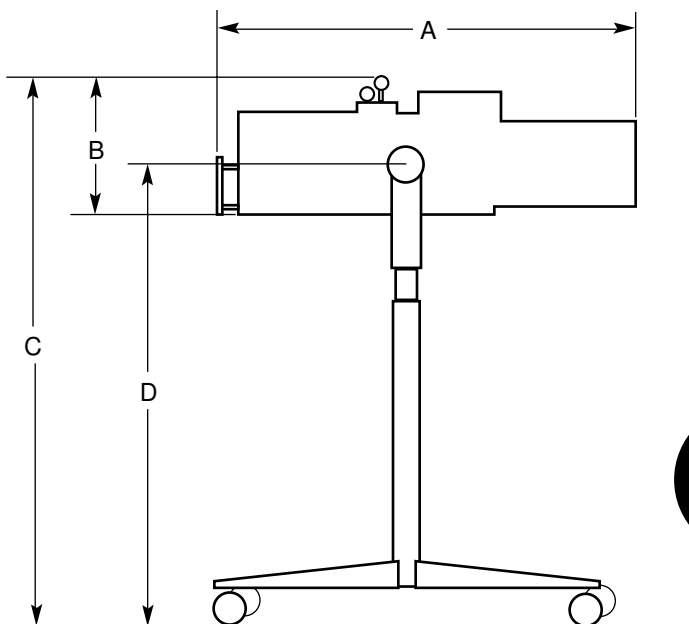

- A. Head length including rear follow handle - 32"
- B. Head height - 14"
- * C. Overall height with base - 54"
- * D. Height of pivot - 44"
- * Additional upward height adjustment of 13"
- Width of base - 26-1/4"
- Maximum width of head - 13-1/2"
- Head weight - 40 lbs.
- Base weight - 21 lbs.



PO Box D, Kings Highway • Sugar Loaf, NY 10981-0214
 Phone: (845) 469-2285 • Fax: (845) 469-5355